

# ATTESTATION



America

Choose certainty.  
Add value.

**Attestation Number:** 721004505 R1

**Issued To:** Swagelok Company  
29500 Solon Road  
Solon, Ohio 44139-3449

**Standards:** Gaseous hydrogen fuelling stations – Part 3: Valves.  
International Standard ISO 19880-3:2018 /  
CSA/ANSI HGV 4.4:21

**Components:** See drawing: CVT SERIES H2 CHECK VALVE Rev.-  
on the 2<sup>nd</sup> page of this Attestation.

As an independent inspection agency, TÜV SÜD America attests that representative components listed on the 2<sup>nd</sup> page of this attestation have met all the design and test qualification requirements of International Standard ISO 19880-3:2018 / CSA/ANSI HGV 4.4:21 - Gaseous hydrogen fuelling stations as applicable. Test results can be found in reports #TR-05589-05-R0 (*Bending Moment*), #TR-05589-06-R0 (*Excess Torque Resistance*), #TR-05589-07-R0 *Swagelok (Pressure Cycle)*, and #TR-05589-08-R0 (*Non-Metallic Material*).

These components were designed and tested for use with compressed hydrogen gas. These components should be installed, used, and maintained in accordance with the manufacturer's Installation / Operation Manual.

**Prepared and approved by:**

A handwritten signature in blue ink, reading 'André Frégeau'.

André Frégeau  
Manager Alternative Fuels  
TÜV SÜD America,  
05/20/2025.



1. PRODUCT TO BE TESTED IN ACCORDANCE WITH ISO 9880-3 AND HGV 4.4.
2. CONNECTION AVAILABLE ONLY IN LIKE-KIND AND SIZE.
3. MARKING METHOD: PRODUCT MARKED ON INLET BODY HEX.
4. OPERATING SPECS:  
NOMINAL PRESSURE RATING: 1050 BAR / 15,228 PSI  
TEMPERATURE RATING: (-40°C TO +85°C)

DWG. NO.	CVT SERIES H2 CHECK VALVE
-------------	---------------------------

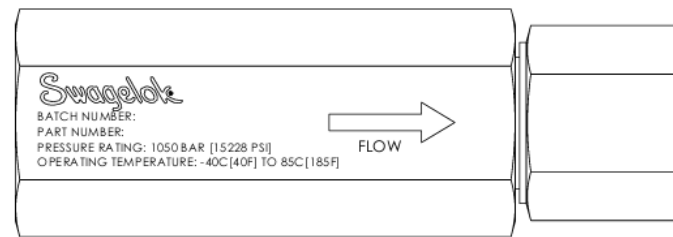

## PRODUCT MARKING

VALVE SIZE / SERIES NUMBER	INLET / OUTLET CONNECTION	BODY HEX SIZE	END SCREW HEX SIZE
CVT6	1/4" FK	1"	3/4"
	1/4" C&T		
	3/8" FK		
	3/8" C&T		
CVT9	1/2" FK	1-1/2"	1-1/4"
	9/16" FK		
	9/16" C&T		
	9/16" FK		
CVT12	9/16" C&T	1-3/4"	1-1/2"
	3/4" FK		
	3/4" C&T		
	3/4" C&T		

ITEM NO.	QTY.	DESCRIPTION	MATERIAL
1	1	INLET BODY	ASTM A276 - 316 S.S.
2	1	O-RING	90 DUROMETER FKM
3	1	BUSHING	UNS C63000
4	1	POPPET	ASTM A276 - 316 S.S.
5	1	COMPRESSION SPRING	ASTM A313 - 316 S.S.
6	1	SPRING CARRIER	ASTM A276 - 316 S.S.
7	1	BEVELVILLE SPRING	ASTM A240/A466 - 316 S.S.
8	1	METAL GASKET	ASTM A240 - 316 S.S.
9	1	END SCREW	ASTM A276 - 316 S.S.

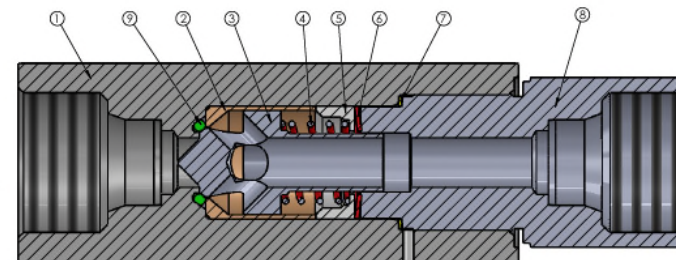
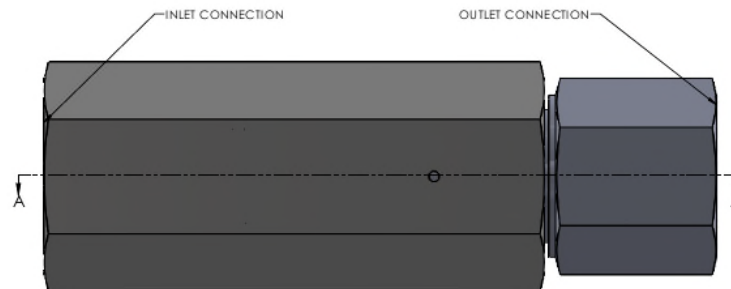

SECTION A-A  
SCALE 3 : 2

THIS PRINT IS THE EXCLUSIVE PROPERTY OF SWAGELOK COMPANY. IT MUST BE RETURNED ON REQUEST ALONG WITH ANY DOCUMENTS CONTAINING INFORMATION OBTAINED FROM THIS PRINT. NEITHER THIS PRINT NOR ANY PART OF IT NOR ANY INFORMATION CONCERNING IT MAY BE COPIED, DISCLOSED TO OTHERS OR USED FOR ANY PURPOSE EXCEPT IN FURTHERANCE OF YOUR BUSINESS WITH SWAGELOK. THE PART IS REFERRED TO ON THIS PRINT MAY BE THE SUBJECT OF PATENTS AND/OR PENDING APPLICATIONS AND MAY NOT BE MANUFACTURED WITHOUT PERMISSION FROM SWAGELOK COMPANY.

UNLESS OTHERWISE SPECIFIED  
DIMENSIONS ARE IN INCHES  
.001 .01  
.003 .005  
.015 .020  
ANGLES .50 MINUTES  
INTERPRET DIM. AND TOL. PER ASME Y14.5M-1994

TITLE CVT SERIES H2 CHECK VALVE ISO 19880-3 WITNESS TESTING APPROVAL			
MATERIAL	SA P CHANGE NUMBER	DCN-00247938	SCALE 1:1
	DATE	1/20/2025	DWG. NO.

Swagelok

	SHEET 1 of 1
VS	00
REV.	-